

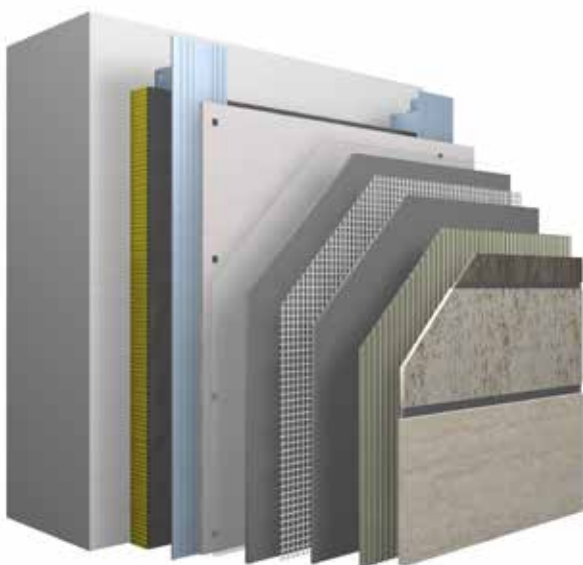

StoVentec Carrier-Board Facade

StoVentec S: Maximum design variety with stone tiles



The StoVentec Carrier-Board Facade is successfully used both in the construction of new buildings and in refurbishment. It provides a quick and high-quality solution especially for moist or extreme substrates with natural stone tiles as the top layer. Thanks to ventilation of the system, the masonry and insulation remain permanently dry, protected and functional. The multilayer structure also adds to improved sound protection. In terms of colour shades and surface textures Sto offers a broad variety of natural stone tiles as the top layer.

StoVentec S

The easy alternative with natural stone panels

StoVentec S is an attractive alternative to heavy, massive natural stone facades and can therefore be used in structurally difficult situations. The system's carrier board forms an excellent adhesion primer for natural stone panel tiles with numerous textures and colour shades. Besides Sto-Natural Stone Tiles, StoDeco Profiles, and Rustications, the StoVentec Carrier-Board Facade is also perfectly suited for the application of ceramics (StoVentec C), glass (StoVentec G), glass mosaic (StoVentec M) and render (StoVentec R).



Photo above and cover picture:
Kantoorpand-Kienhuis-Hoving, office building Drienerbeek,
Enschede, Netherlands
Architect: I/AA Architekten & Ingenieurges, Enschede, Netherlands

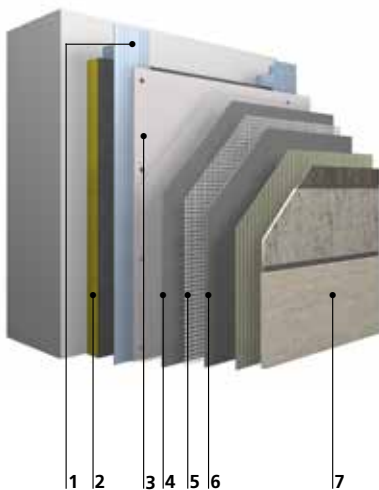

StoVentec S
system build-up

- 1 Sub-construction
- 2 Insulation
- 3 Carrier board
- 4 Primer
- 5 Base coat
- 6 Reinforcing coat with glass fibre mesh
- 7 Top coat:
natural stone panel tiles

Overview of StoVentec S

Areas of application:

- Existing and new buildings. Installation limits according to national building regulations
- Wall structures: masonry (concrete, lime sandstone, brick, porous concrete), concrete slab construction (three-layer concrete slab) and fair-faced masonry
- Levels unevenness by means of a flexible sub-construction
- Onto external walls in timber construction

Properties:

- Lowest thermal bridge coefficients due to own sub-construction made from a combination of stainless steel and aluminium
- Improvement of up to 10 dB (A) in the airborne sound insulation index
- Highly effective thermal insulant
- Highly weather-resistant
- Limited combustibility
- Non-combustible with StoVentec Carrier Board A and mineral coating procedure (A2 s1 d0 in accordance with DIN EN 13501 after permission from the responsible authority where necessary)
- Very high crack resistance
- Highly resistant to mechanical stress
- Resistant to microorganisms (algae, fungi)

Appearance:

- Sto-Natural Stone Tiles
- Can be combined with StoDeco Facade Profiles and StoDeco Rustications

Application:

- Complete detail solutions
- Fast installation
- Curvatures can be implemented

Approvals:

The relevant European and/or national approvals apply.

Head office

Sto SE & Co. KGaA

Market Development

Ehrenbachstrasse 1
79780 Stuehlingen
Germany

Phone +49 7744 57-1131

Fax +49 7744 57-2428

infoservice@sto.com

www.sto.com



The detailed technical specifications and information on the products contained in the Technical Data Sheets and approvals must be observed.