



www.blauer-engel.de/uz140

StoTherm Mineral

Non-combustible external wall insulation system, especially suitable for high-rise and public buildings

External wall insulation systems, which are used above high-rise level, are required by law to consist of non-combustible components. StoTherm Mineral is a reliable non-combustible system. It combines broad scope for design with suitability for virtually any type of substrate. StoTherm Mineral enables the use of many paste-form finishing renders from Sto, such as Stolit®, StoSilco®, StoSilco® blue or StoSil®. These are highly functional and therefore water or dirt-repellent. They are available in intensive colour shades, as well as being resistant to cracking, which means that they provide permanently beautiful facades.

As a complete system that has been awarded the "Blue Angel" (RAL-UZ 140 according to RAL gGmbH certification), StoTherm Mineral is also the sustainable alternative when it comes to increased requirements for environmental protection.

StoTherm Mineral

The mineral, non-combustible system – with the "Blue Angel" award

With StoTherm Mineral and Lotusan®, the intelligent facade paint with Lotus-Effect® Technology, Sto offers a facade solution which does not require any biocide film protection and with the "Blue Angel" for excellent, environmentally sound thermal protection (according to RAL gGmbH certification).

System advantages

- Non-combustible
- Large selection of finishing renders
- Decorative facade design with ceramics and natural stone
- High resistance to microorganisms (algae and fungi), particularly with a supplementary paint build-up (incl. prime coating)
- Highly weather-resistant
- Permeable to water vapour and CO₂

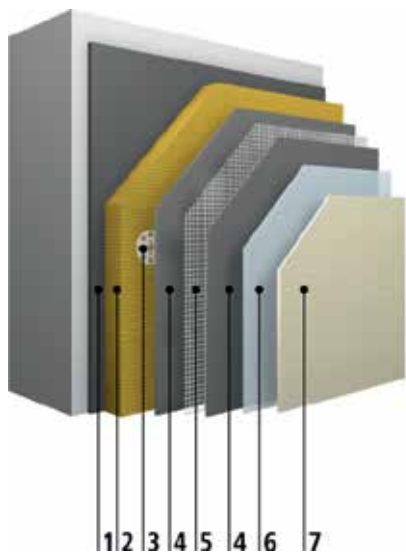

1. Adhesive
2. Insulation
3. Fixing
4. Base coat
5. Reinforcement
6. Intermediate coat
7. Finish

Overview of StoTherm Mineral

Areas of application	<ul style="list-style-type: none"> • New and existing buildings up to a height of 100 m • Especially suitable for high-rise buildings, public buildings, and special constructions • Suitable for passivhaus standard
Substrate	<ul style="list-style-type: none"> • Masonry, such as brick, calcium silicate masonry units, cellular concrete, fair-faced masonry and masonry veneer • Concrete, concrete slab construction (three-layer concrete slabs) • Timber construction (solid, frame, and panel construction) • Steel construction (column and framing) • Existing external wall insulation systems (doubling-up)
Fixing	<ul style="list-style-type: none"> • Bonding, for unevenness of the substrate ≤ 1 cm/m (in solid construction) • Bonding and fixing with anchors, for unevenness of the substrate ≤ 2 cm/m (in solid construction) • Mechanical fixing with Sto-Rotofix plus
Thermal protection	<ul style="list-style-type: none"> • Insulation board made of mineral wool up to 300 mm • In case of natural stone and ceramic cladding up to 200 mm
Reaction to fire	<ul style="list-style-type: none"> • Non-combustible, class A2-s1, d0, in accordance with EN 13501-1
Impact resistance	<ul style="list-style-type: none"> • Mechanically resistant
Other properties	<ul style="list-style-type: none"> • Lotus-Effect® Technology optional • Anti-electrosmog optional
Design options	<ul style="list-style-type: none"> • Organic and silicone resin renders as well as render with the Lotus-Effect® Technology as well as mineral and silicate renders in stippled or rilled render textures or as free-style textured render • Three-dimensional facade elements made of Verolith granulate • Natural stone tiles, brick slips, and ceramic tiles and boards
Colour range	<ul style="list-style-type: none"> • Limited tintability in accordance with the StoColor System • Light reflectance value ≥ 20 %
Application	<ul style="list-style-type: none"> • Suitable for application by machine • Stop & Go technology • QuickSet and FastTrack technologies make it possible to carry out projects during the colder seasons • Double paint coat may be necessary depending on the render type and colour shade • No paint coat necessary for organic finishing renders • A double coat of paint offers special protection against algae and fungi
Notes	<ul style="list-style-type: none"> • System components of the "Blue Angel" eco-label are listed in the certificates.
Approvals	<ul style="list-style-type: none"> • The relevant national approvals apply. • The "Blue Angel" for external wall insulation systems – RAL-UZ certificate no. 24769 (StoTherm Mineral L) • The "Blue Angel" for external wall insulation systems – RAL-UZ 140 certificate no. 24770 (StoTherm Mineral)

Headquarters Germany

Sto SE & Co. KGaA

Market Development

Ehrenbachstrasse 1
79780 Stuehlingen

Phone +49 7744 57-1131

Fax +49 7744 57-2428

infoservice@sto.com

www.sto.com



The detailed technical specifications and information on the products contained in the Technical Data Sheets and approvals must be observed.